



Product Overview

EKC2S series AC Contactor with novel appearance and compact structure is suitable for using starting & controlling the AC motor frequently, switching on and off the circuit at a long distance. It is used in combination with thermal relay to compose a magnetic motor starter. Standard: IEC 60947-4-1.

Specifications

- Rated operation current(Ie): 9-95A;
- Rated operation voltage(Ue): 220V~690V;
- Rated insulation voltage: 690V;
- Poles: 3P;
- Installation: Din rail and screw installation

Operating and Installation Conditions

Type	Operating and Installation Conditions
Installation category	III
Pollution level	3
Certification	CE, CB, TUV
Protection degree	EKC2S-09~38: IP20; EKC2S-40~95: IP10
Ambient temperature	limit of temperature: -35°C~+70°C, normal temperature: -5°C~+40°C, The average no more than +35°C within 24 hours. If not in normal operating temperature range, please refer to "Instructions for abnormal environment"
Altitude	≤2000m
Ambient temperature	The maximum temperature of 70 degrees, the air relative humidity not exceed 50%, under lower temperature can allow for higher relative humidity. If the temperature is 20°C, the air relative humidity could up to 90%, Special measures should be taken for occasional condensation due to humidity changes.
Installation position	Inclination between installation surface and vertical surface should not exceed ±5°
Shock vibration	Products should be installed and used without significant shake, shock and vibration place.

Specifications

Appearance



Type EKC2S-09 EKC2S-12 EKC2S-18 EKC2S-25 EKC2S-32 EKC2S-38 EKC2S-40 EKC2S-50 EKC2S-65 EKC2S-80 EKC2S-95

Main circuit characteristic

Poles		3P												
Rated insulation voltage(Ui)		V	690											
Rated operating voltage(Ue)		V	380/400, 660/690											
Rated thermal current(Ith), AC-1			20	20	32	40	50	50	60	80	80	125	125	
Rated operation current(Ie)	AC-3,380/400V	A	9	12	18	25	32	38	40	50	65	80	95	
	AC-3,660/690V	A	6.6	8.9	12	18	22	22	34	39	42	49	49	
	AC-4,380/400V	A	3.5	5	7.7	8.5	12	14	18.5	24	28	37	44	
	AC-4,660/690V	A	1.5	2	3.8	4.4	7.5	8.9	9	12	14	17.3	21.3	
Rated operational power(Pe)	AC-3,380/400V	kW	4	5.5	7.5	11	15	18.5	18.5	22	30	37	45	
	AC-3,660/690V	kW	5.5	7.5	10	15	18.5	18.5	30	33	37	45	45	
	AC-4,380/400V	kW	1.5	2.2	3.3	4	5.4	5.5	7.5	11	15	18.5	22	
	AC-4,660/690V	kW	1.1	1.5	3	3.7	5.5	6	7.5	10	11	15	18.5	
Mechanical life			1200				1000				900		650	
Electrical life	AC-3	10000 times	110				90				65			
	AC-4		22				22				17			
Frequency of operation	AC-3	times/hour	1200				600				300			
	AC-4		300				300				300			

Connecting capability of main circuit terminal

Flexible wire	1 wire	mm ²	1...4				1.5...6				2.5...25		4...50	
No terminal	2 wire	mm ²	1...4				1.5...6				2.5...16		4...25	
Flexible wire	1 wire	mm ²	1...4				1...6				2.5...25		4...50	
With terminals	2 wire	mm ²	1...2.5				1...4				2.5...10		4...16	
Hard wire	1 wire	mm ²	1...4				1.5...6		1.5...10		2.5...25		4...50	
No terminal	2 wire	mm ²	1...4				1.5...				2.5...10		4...25	
Fastening torque		N·m	1.2				1.8				5		9	

Coil

Rated control voltage(Us)	50Hz	V	24, 36, 48, 110, 127, 220/230, 240, 380/400, 415, 440											
	50/60Hz	V	24, 36, 48, 110, 127, 220/230, 240, 380/400, 415, 440											
Allowed control circuit voltage(Us)	Operation	V	Installation inclination angle ±22.5°: 85%~110%Us; Installation inclination angle±5°: 70%~120%											
	Release	V	Installation inclination angle ±22.5°: 20%~75%Us; Installation inclination angle±5°: 20%~65%											
Power consumption of coil	Actuation	VA	60				70				200		200	
	Keep	VA	6-9.5				6-9.5				15-20		15-20	
	Consumption	W	1-3				1-3				6-10		6-10	

Auxiliary contacts

Auxiliary contacts specification		A	11									
Rated thermal current (Ith)		A	10									
Rated operating voltage (Ue)	AC	V	380									
	DC	V	220									
Rated control capacit	AC-15	VA	360									
	DC-13	W	33									

Certification

CE, TUV, CB

Overall and Mounting

EKC2S-09~38

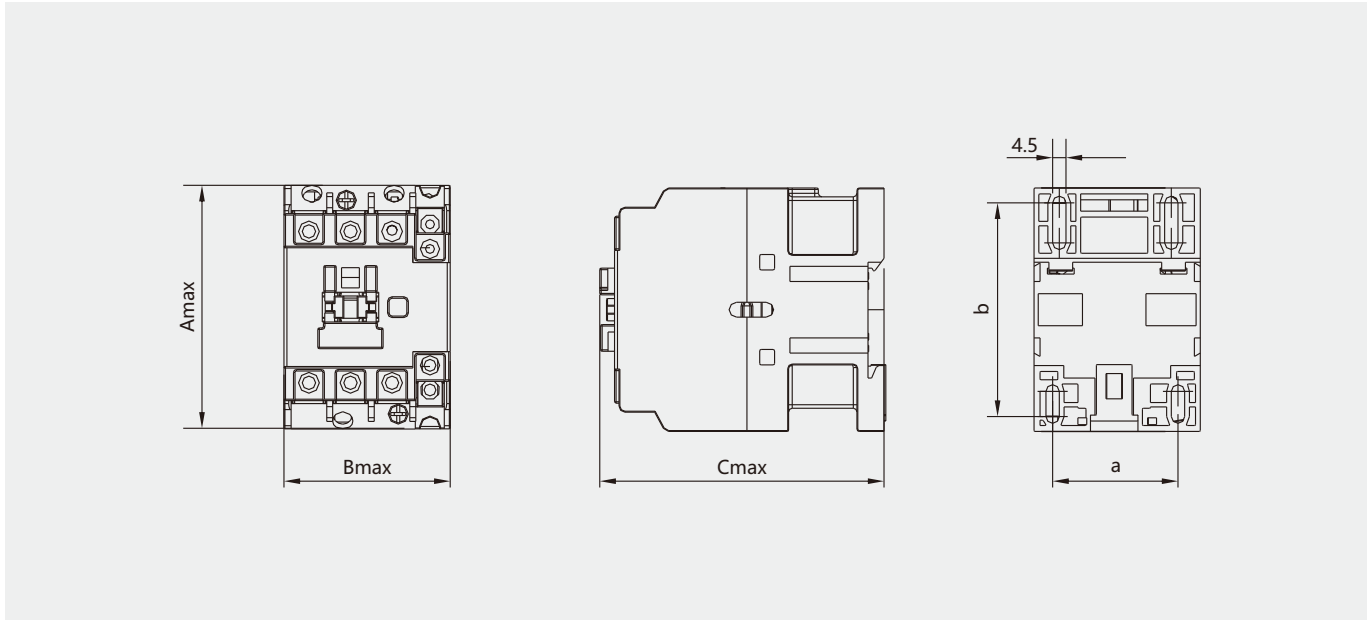

EKC2S-40~95

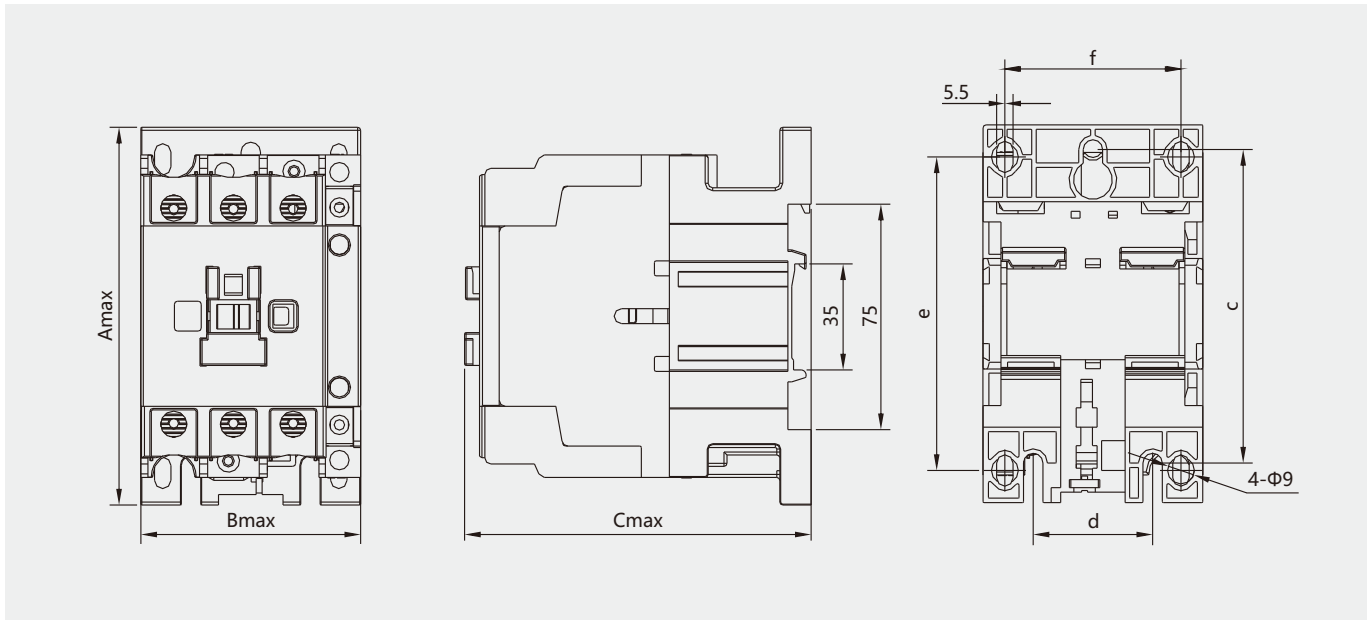

Type	A_{max}	B_{max}	C_{max}	a	b	c	d	e	f
EKC2S-09, 12, 18	74.5	45.5	85.5	35	50/60	-	-	-	-
EKC2S-25, 32, 38	83	56.5	97	40	50/70	-	-	-	-
EKC2S-40, 50, 65	127.5	74.5	117	-	-	105	40	100/110	59
EKC2S-80, 95	127.5	85.5	125.5	-	-	105	40	100/110	67