

Usage Manual



Changeover Switch

No.288th. Wei 17 Road, Economic Development
Zone, Yueqing City Zhejiang China.
Tel: 0086-577-62718777 Fax: 0086-577-62774090
Email: sales@etek-china.com

Thank you for choosing EKCS101 Series Changeover Switch.
Please read this manual before installation, operation and maintenance.

STANDARD AND QUALITY CERTIFICATES

IEC60947-3



The Changeover Switch can switch on, Load and break the circuit under normal conditions, using as Switch Disconnectors.

| | | |
|---------------------|---------------------|--|
| Technical Data | Rated Voltage | 240/415V~ |
| | Rated Current | 16,25,32,40A |
| | Rated Frequency | 50/60Hz |
| | Number of Poles | 1,2,3,4P |
| | Contact form | 1-0-2 |
| Electrical Features | Electrical Life | 1500 Cycles |
| | Mechanical Life | 8500 Cycles |
| | Protection degree | Ip20 |
| | Ambient Temperature | -5°C...40°C |
| Electrical Features | Terminal/Cable size | 16mm ² |
| | Mounting | On DIN rail EN60715(35mm) by means of fast clip device |

EKCS101/1P Overall and Installation Dimension(mm)

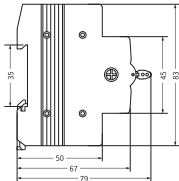

EKCS101/2P Overall and Installation Dimension(mm)

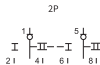
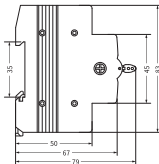

EKCS101/3P Overall and Installation Dimension(mm)



3P

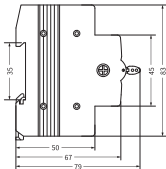

EKCS101/4P Overall and Installation Dimension(mm)

